

# SEVENOAKS SCHOOL

## Parking

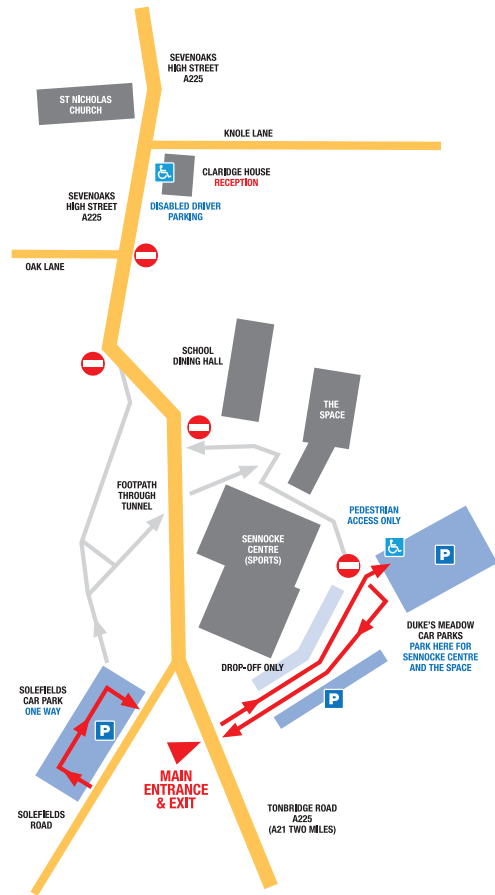

## How to find us

### BY ROAD

Sevenoaks School is about 10 minutes drive from Junction 5 of the M25, the London Orbital Motorway. It is also within reach of the M20 and M2 motorways, and the A21 London to Hastings trunk road.

#### From M25 (west)

Leave at Junction 5 (A21 Hastings). Immediately take the A25 turn-off (Riverhead) to the roundabout at Riverhead. Turn right and follow the road past Sevenoaks Station and up into Sevenoaks. Go right through the town towards Tonbridge. Soon after the church the road bends to the left, after which the school's Duke's Meadow car park is the second entrance on the left. Solefields car park is in Solefields Road, opposite the entrance to Duke's Meadow.

#### From M26 (east)

Leave at Junction 2A, follow signs to A25 (Sevenoaks). After passing through Seal turn left at the traffic lights, follow the road up into the town and on towards Tonbridge. Soon after the church the road bends to the left, after which the school's Duke's Meadow car park is the second entrance on the left. Solefields car park is in Solefields Road, opposite the entrance to Duke's Meadow.

#### From A21 (south)

Leave the A21 at the Sevenoaks turn off, south of the town. At this roundabout, take the third turning (Sevenoaks). Half a mile from the top of the winding hill, you will reach the school on your right, just prior to the town centre.

### Disabled access

Disabled parking is available in The Flat car park, via Duke's Meadow entrance. Please let us know if you require disabled parking. Any prospective parent who requires wheelchair access when they visit the school is encouraged to contact the Admissions department in advance.

### BY AIR

Sevenoaks School is 30 minutes drive from London Gatwick and about 50 minutes drive from London Heathrow. Other airports within easy reach are London City and London Stansted. On request, the school will organise taxis for pupils to and from airports and ensure taxi sharing where possible. Parents are charged for the cost of the taxi.

### BY RAIL

Fast trains run from London Charing Cross, London Waterloo East, London Bridge and London Cannon Street (30 minutes) as well as from the Channel Ports and Ashford International with its Eurostar connections to Paris and Brussels. Sevenoaks Station is within walking distance (15 minutes) of the school and taxis are available at the station.

### BY BUS

For daily journeys to and from school, the Parents' Association organises for pupils from the following places: Tunbridge Wells, the Westerham area, Bromley and Orpington, and the Battle area. The school also provides a daily minibus service to and from the station. Charges for these services are placed on school accounts.

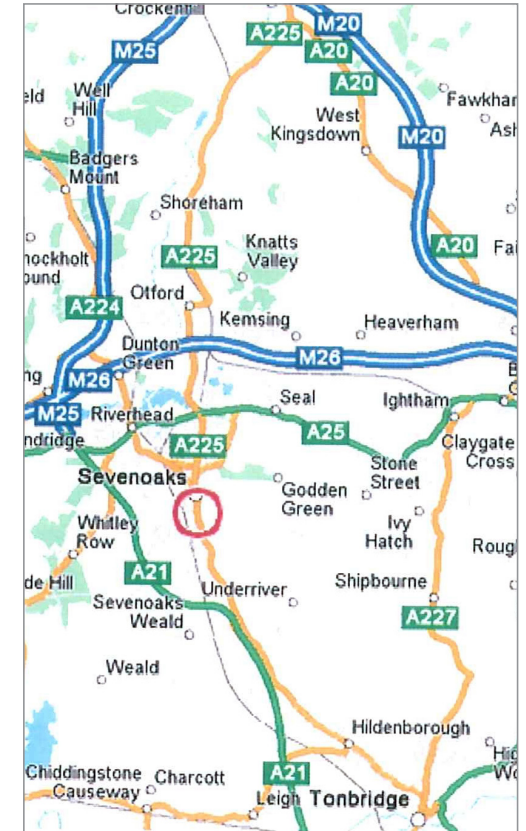

Map © Tele Atlas / © 2007 Crown Copyright  
Revised 2008

# SEVENOAKS SCHOOL

## Campus map



- |                               |                                 |                               |
|-------------------------------|---------------------------------|-------------------------------|
| 1. Claridge House             | 18. Art, Languages, Dining Hall | Sports facilities             |
| 2. St Nicholas Church         | 19. Science and Computing       | 34. Athletics track           |
| 3. Manor House                | 20. Swanzy Block                | 35. Sennocke Centre           |
| 4. Girls' International House | 21. Old School                  | 36. Bailey Tennis Centre      |
| 5. Temple House               | 22. Almshouses                  | 37. Top Astro pitch           |
| 6. Temple Classroom           | 23. Froy Gates                  | 38. Lower Astro pitch         |
| 7. Sennocke House             | 24. Pedestrian underpass        | 39. Post Office Tennis Courts |
| 8. Biology laboratories       | 25. Duke's Meadow car park      | DM Duke's Meadow pitches      |
| 9. Meeting House              | 26. Solefields Road car park    | PG Park Grange pitches        |
| 10. Head's House              | 27. Design Technology           |                               |
| 11. Medical Centre            | 28. Estates Department          |                               |
| 12. Cottage Block             | 29. International Centre        |                               |
| 13. Johnson Library           | 30. Park Grange                 |                               |
| 14. Aisher Hall               | 31. Lambardes                   |                               |
| 15. Marley Centre             | 32. School House                |                               |
| 16. The Space                 | 33. Johnsons                    |                               |
| 17. Sackville Theatre         |                                 |                               |

